

CMX18 EXCAVATOR CHARGING INSTRUCTIONS



1 - Locate & set aside the battery cable. Set it aside. Do NOT plug in the battery cable yet.



2 - The red cord is the primary charging cord.



3 - The blue cord is the secondary charging cord.

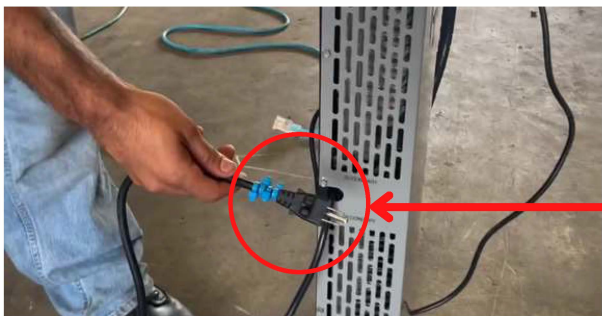

CMX18 EXCAVATOR CHARGING INSTRUCTIONS (CONTINUED)



4 - Plug in the Red Primary cord first. Do not plug in the blue secondary cord until the red primary cord has been plugged in



5 - After the red primary cord has been plugged in, now plug in the blue secondary cord

CMX18 EXCAVATOR CHARGING INSTRUCTIONS (CONTINUED)



6 - Now you can plug in the battery cable into the charging port.



7 - Wait 30 seconds, the meter should read at (or close to) -44 amps.

If the meter reads less than -22 amps, repeat these steps.